

Automotive / Appliance control - sensor

# 10 mm carbon potentiometer PT10

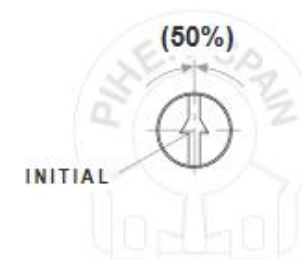

Rotors (Default delivery is at initial position. Wipers are shown positioned at 50% for the picture)

Without shaft or knob.

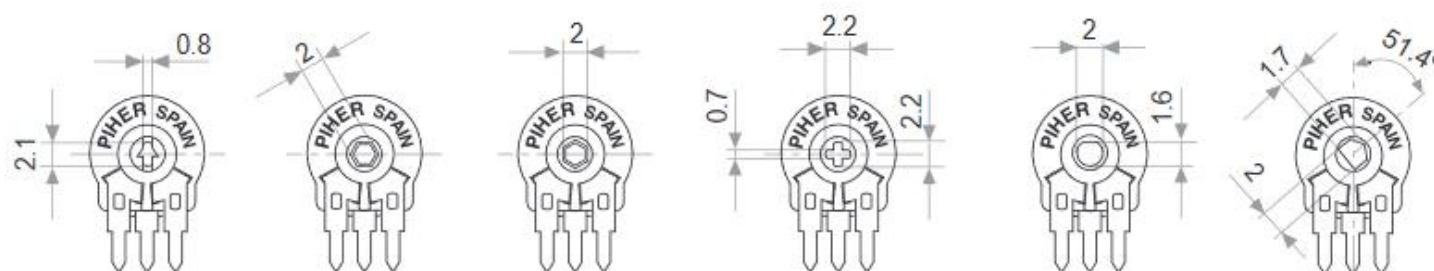

**L** = Screwdriver

**M** = Hexagonal

**G** = Hexagonal

**K** = Cross slot

**R**

**B**

All rotors are thru-hole.

With inserted shaft.

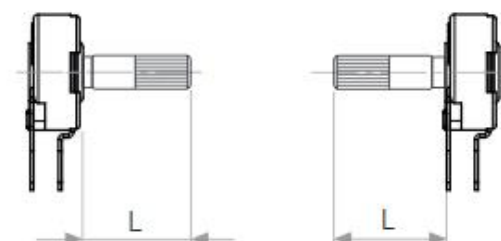

**X** =  
Adjustable from  
collector side

**W** =  
Adjustable from  
terminal side

With knob/humbwheel inserted

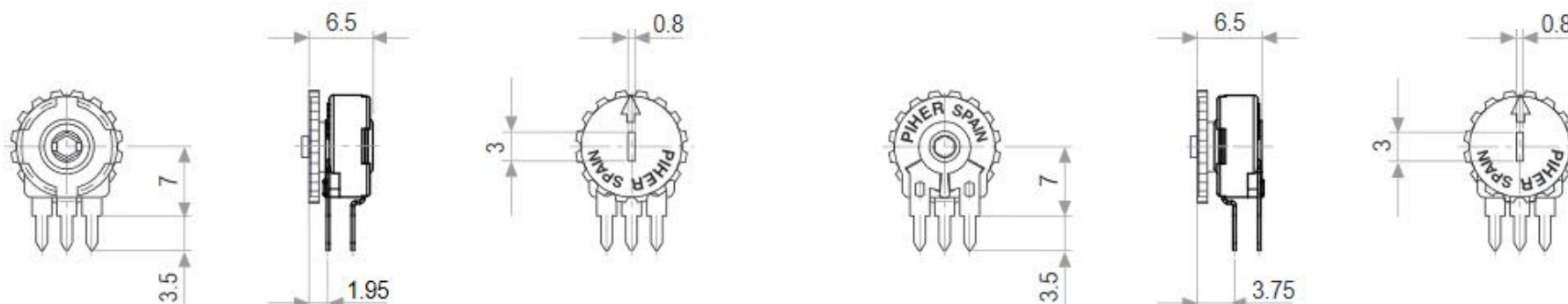

**Y** = Adjustable from terminal side (default knob is 5034).

**Z** = Adjustable from collector side (default knob is 5034).

# 10 mm carbon potentiometer PT10

## Shafts

For G and M rotor types, top view.

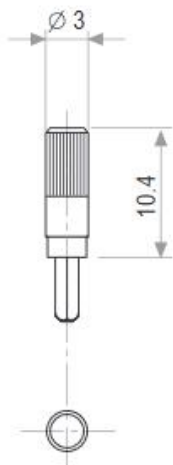

Fig. 1 / Ref. 5016

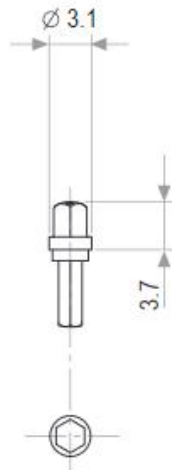

Fig. 2 / Ref. 5053

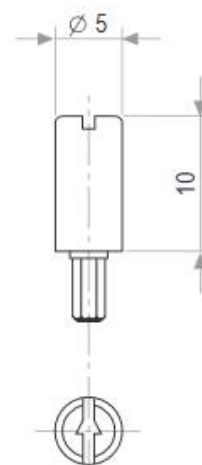

Fig. 3 / Ref. 5012

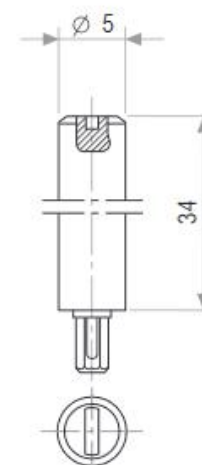

Fig. 4 / Ref. 6053

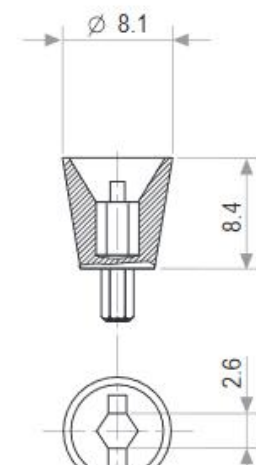
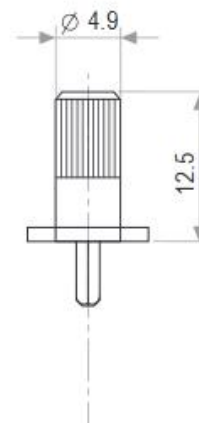
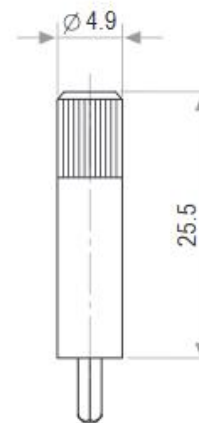
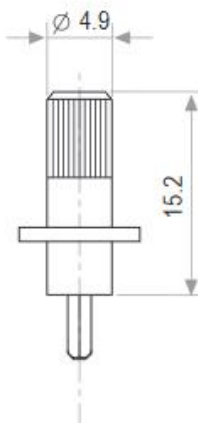
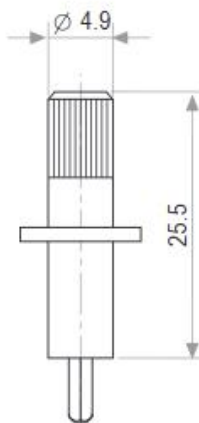

Fig. 6 / Ref. 5035



# 10 mm carbon potentiometer PT10

## Knobs/thumbwheels

For G and M rotor types, top view.

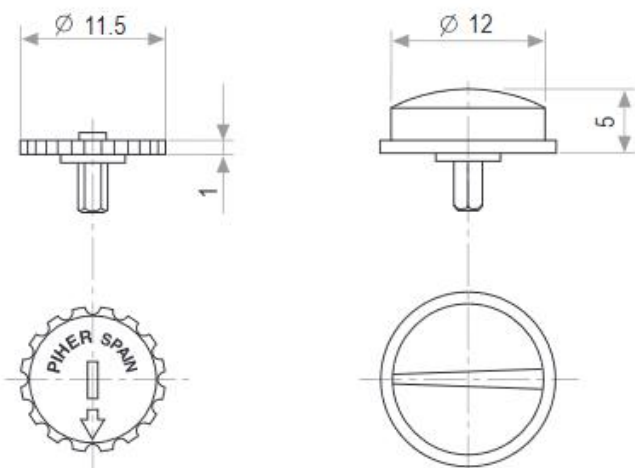

Fig. 5 / Ref. 5034

Fig. 15 / Ref. 6008

2- GANG Plastic Knob/ Plastic Shaft

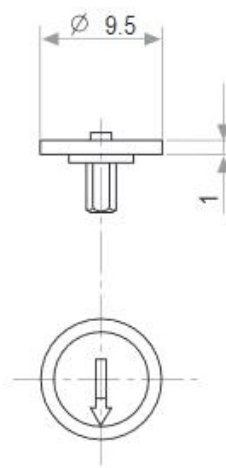
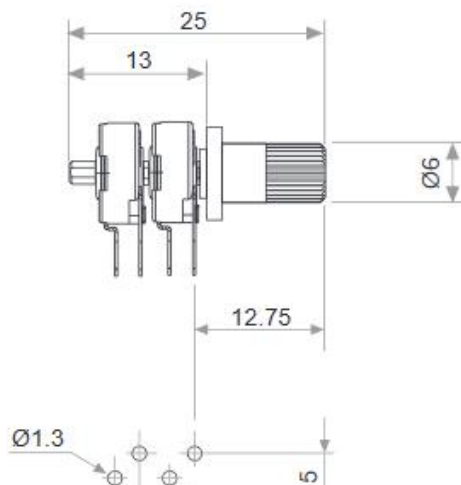

Fig. 16 / Ref. 5039

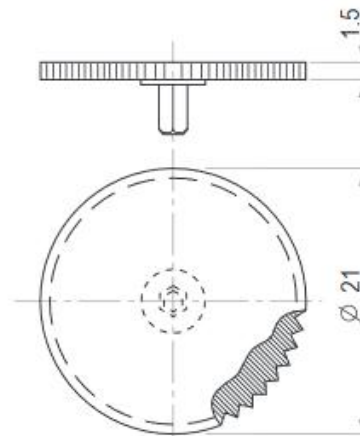
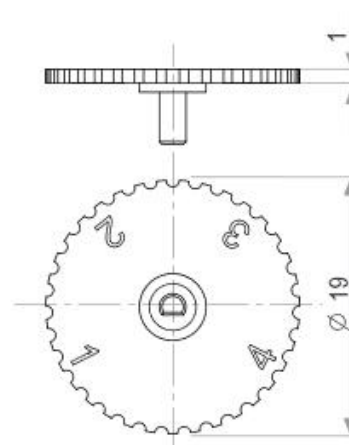

Fig. 17 / Ref. 5062

Numbered Thumbwheel



By default, shafts, knobs & thumbwheels are delivered unassembled.

Mounted shafts, knobs & thumbwheels are delivered at random position but can be delivered at specific positions too (a drawing must be provided by the customer).

If you need the shaft or knob to be delivered assembled from the factory, please select the appropriate rotor in the part number: X, W, Y or Z.

The plastic color can be stated in the part number. Non flammable plastic can be ordered too.

If the potentiometer is ordered with non flammable plastic materials (UL 94V0) then the shaft or knob will be delivered with non flammable plastic too.

If you wish to use your own plastic shaft/knob/actuator, please, contact Piher for advice about compatible materials.

**V10**

